

Bi-Folding Door

Installation Guide

Section A

Door Installation A1 - A7

Section B

Lock Adjustment B1



Section C

Kit-Form Pre-Assembly C1 - C2

Section D

De-Glazing Instruction D1



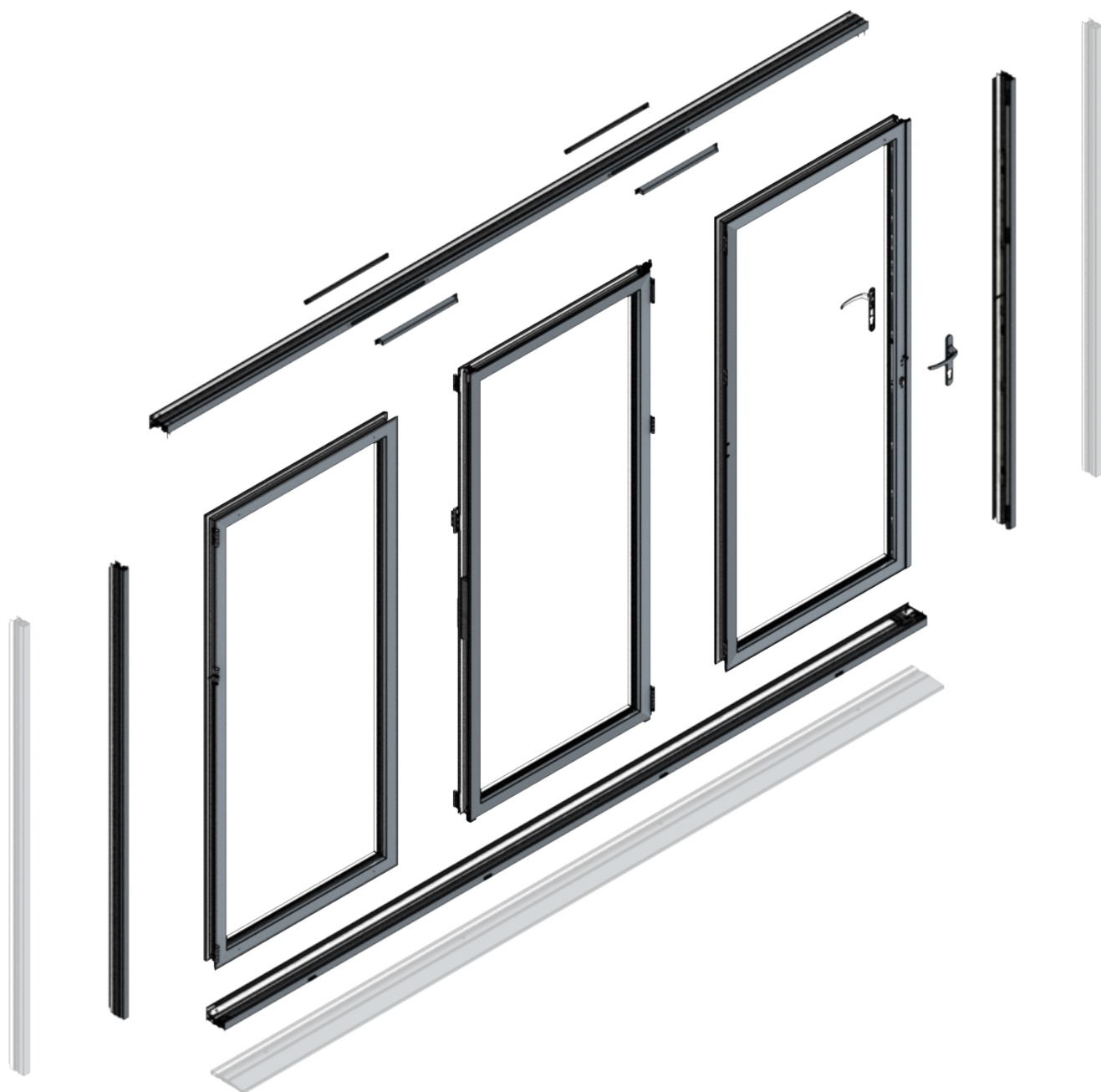

TOOLS REQUIRED

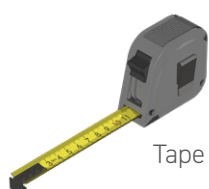

Tape measure

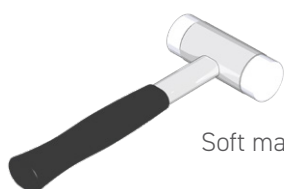

Soft mallet

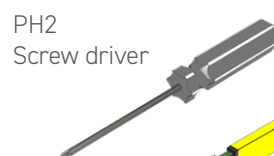

PH2
Screw driver

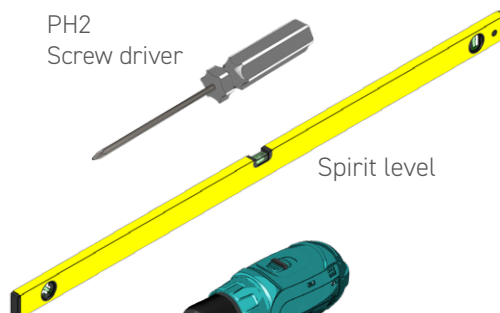

Spirit level



4mm hex key



Glazing paddle

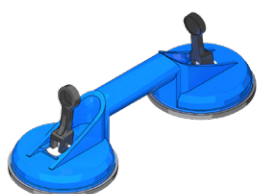

Glazing suction lifters



Cordless
drill / driver



Pozi No 2
Bit



3 & 5mm
Drill Bits

PACKAGING CONTENTS

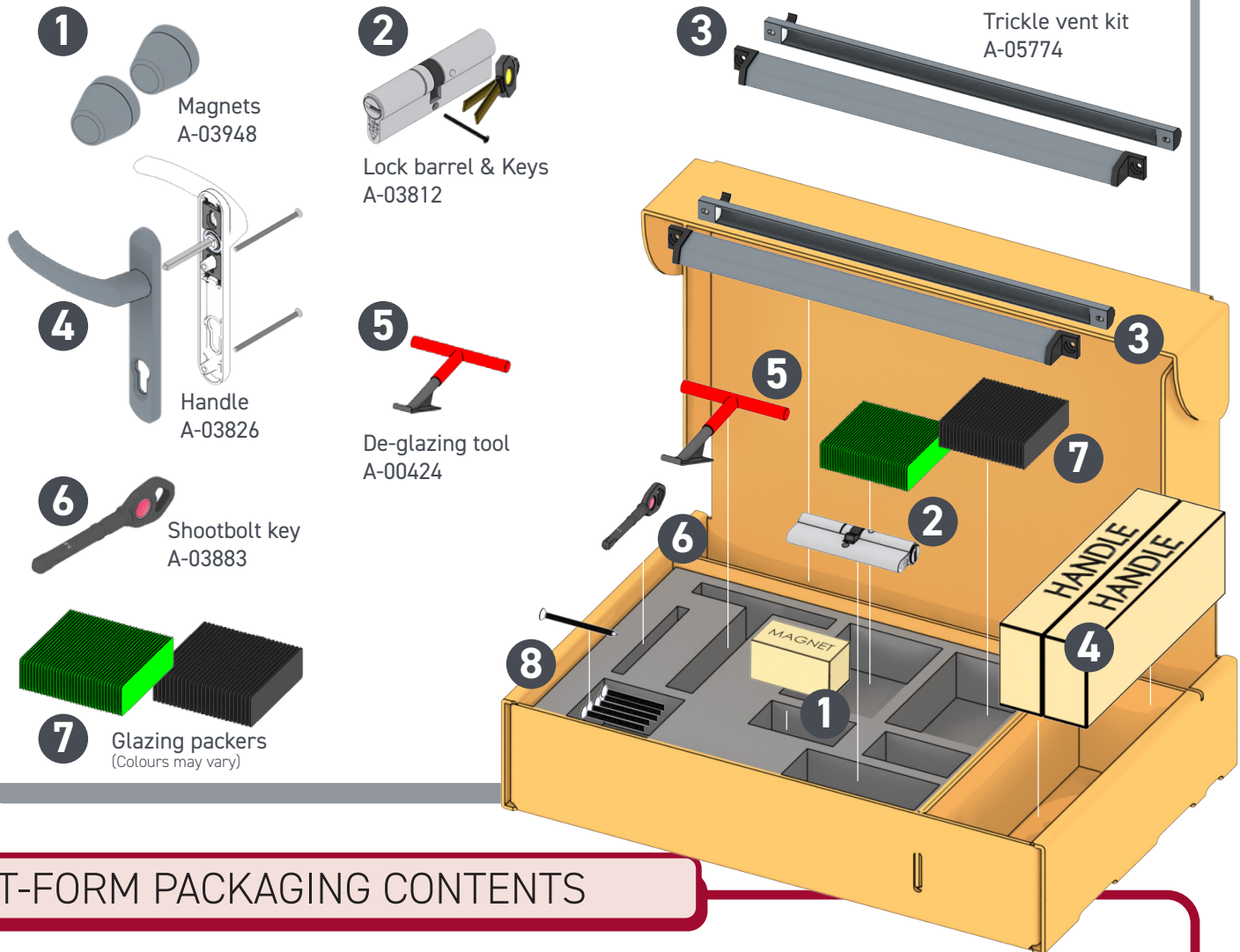

KIT-FORM PACKAGING CONTENTS



CONSUMABLES - NOT SUPPLIED

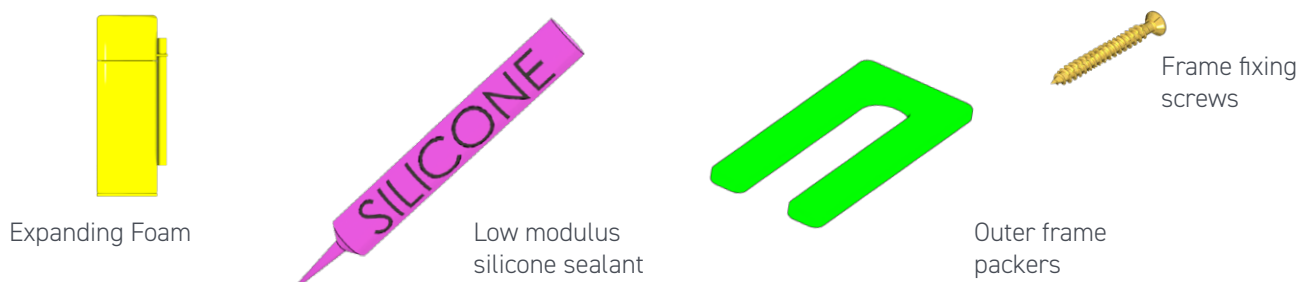

BEAD UNPACKING

A1

1 Bead and bead spacer removal before installation

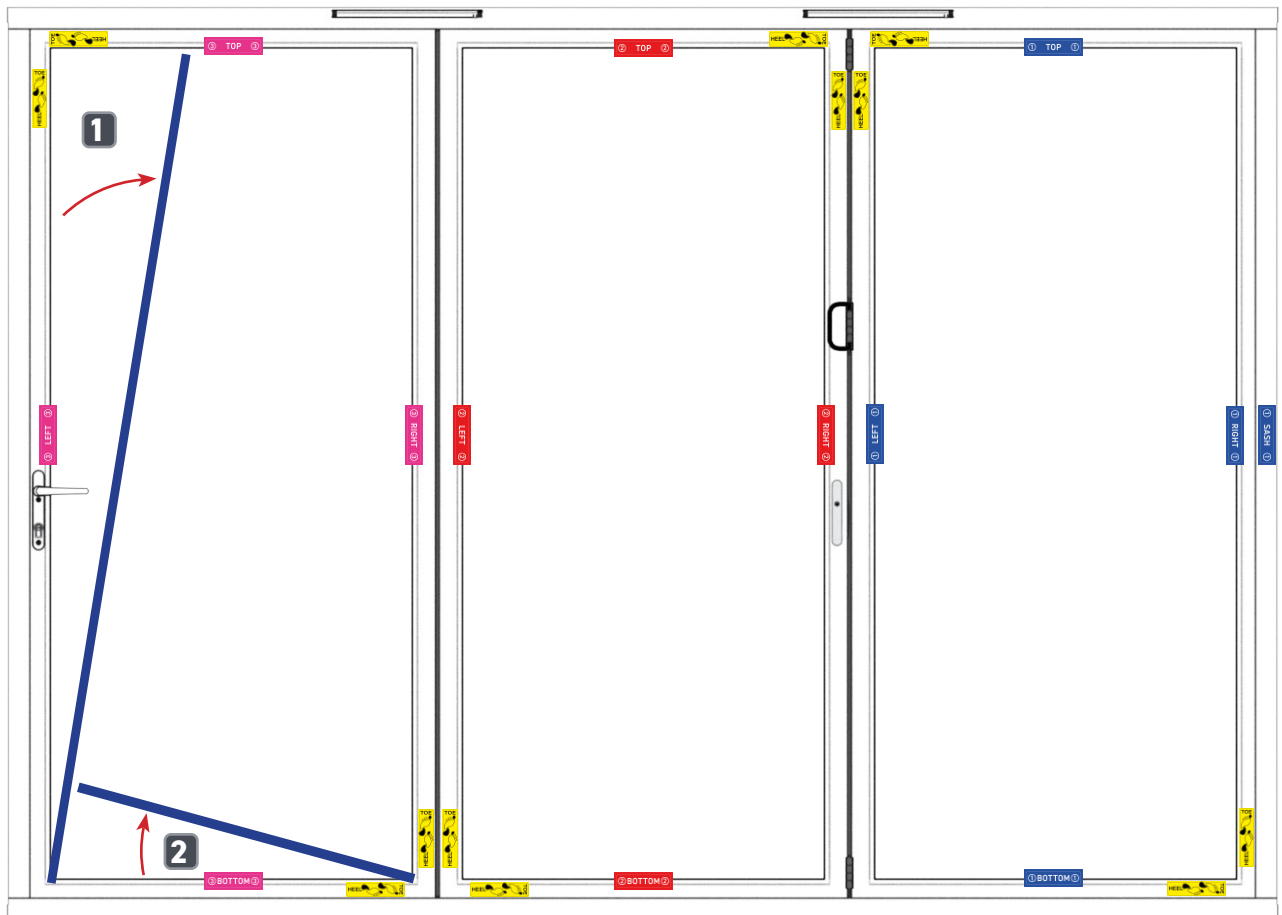

Beads must return to original positions

Polystyrene bead spacer removal

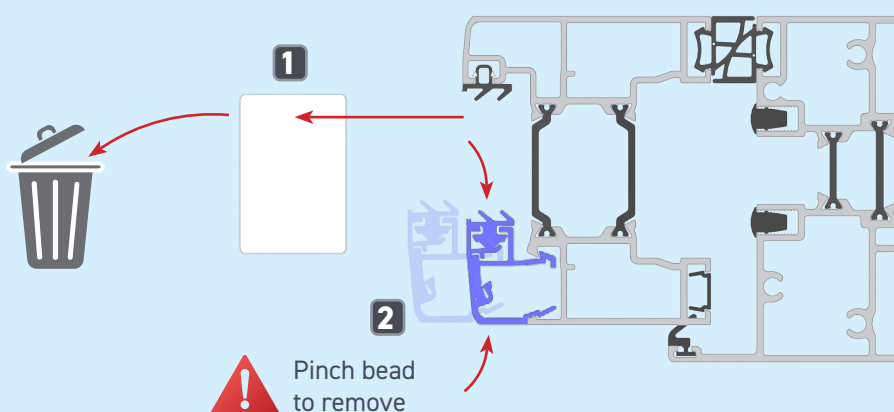

GENERAL ASSEMBLY

HANDLE INSTALLATION

A2

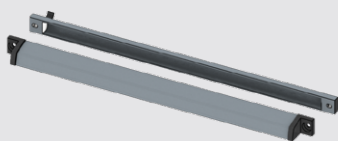

Trickle vent kit
A-05774

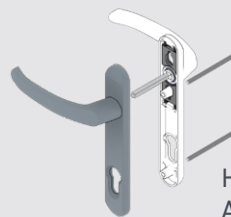

Handle Sets
A-03826

1 Handle assembly

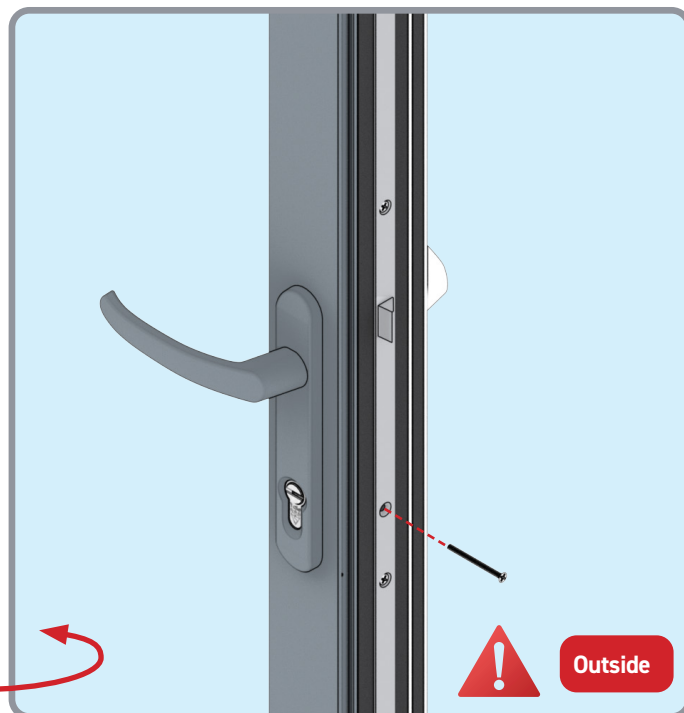
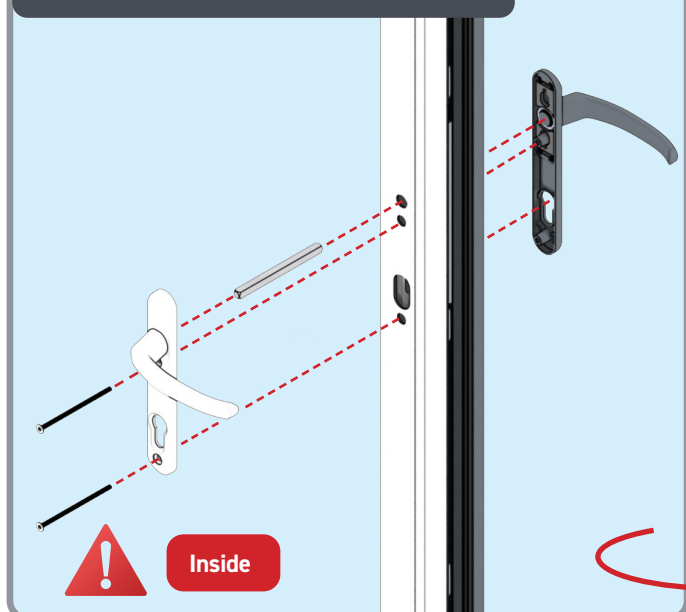

OPTIONAL TRICKLE VENT INSTALLATION

1 Trickle vent assembly

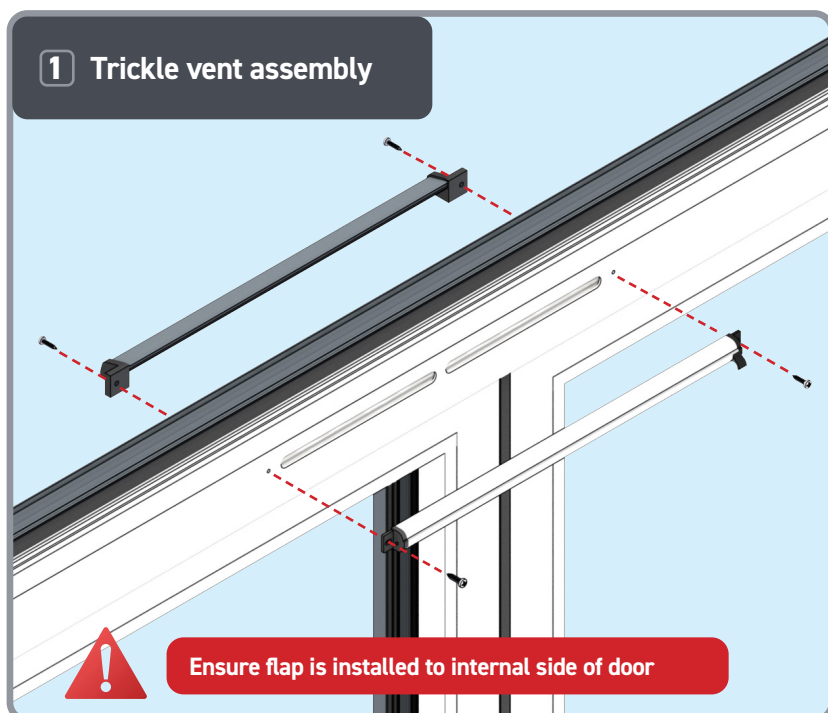

2

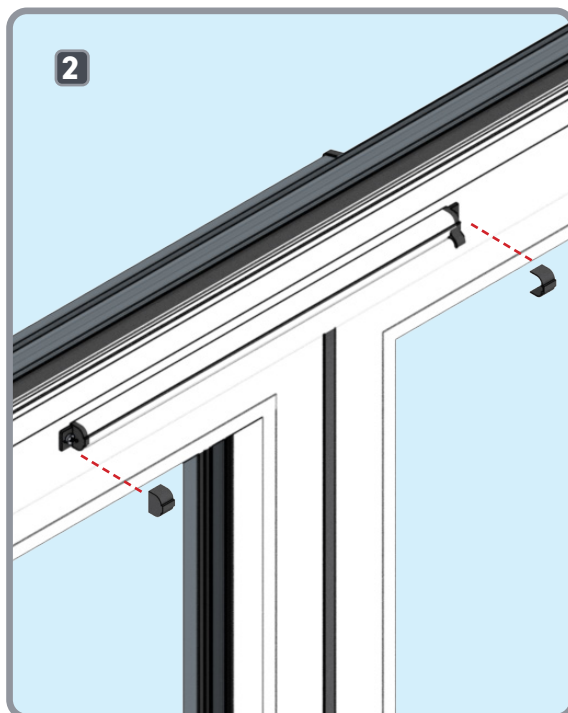

CILL INSTALLATION

A3



Outer frame
packers
(not supplied)

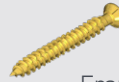

Frame fixing
screws
(not supplied)



Low modulus
silicone sealant
(not supplied)

1 Drilling

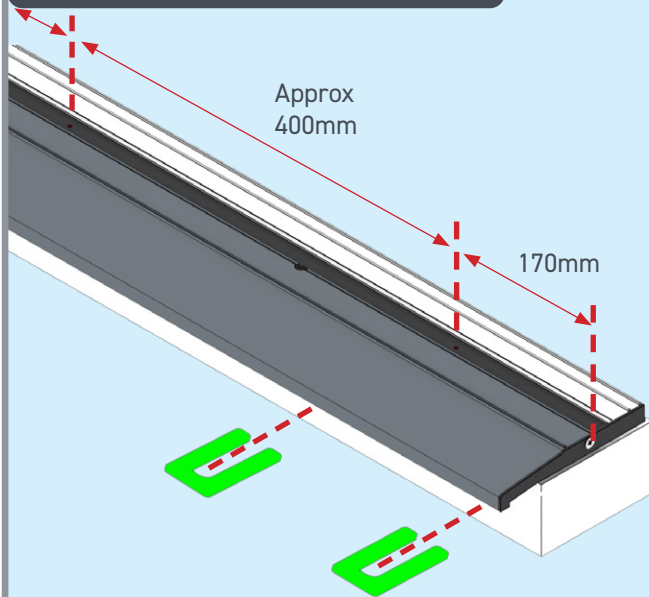

2 Leveling and fixing cill

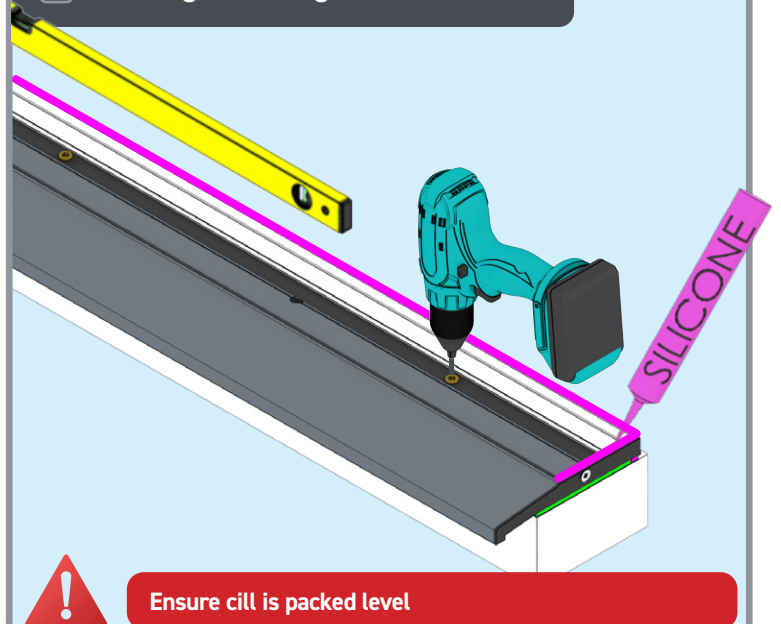

Ensure cill is packed level

3 Completed cill position showing packer

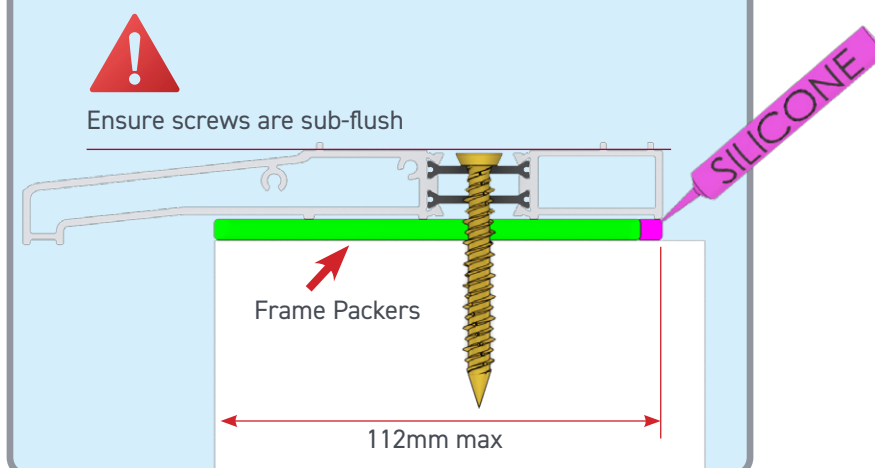

Note - Cill packers and screws are not supplied

Ensure cill is level: $\pm 1\text{mm}$

DOOR POSITIONING

A4



Use screwdriver not drill

1 Keep screw access covers removal when on jamb



40mm 1:1



Only remove fixing screws

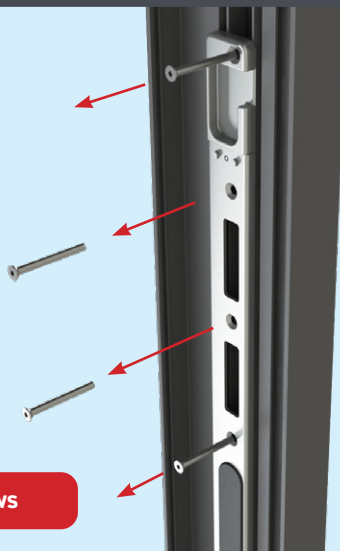

2 Vertical Alignment

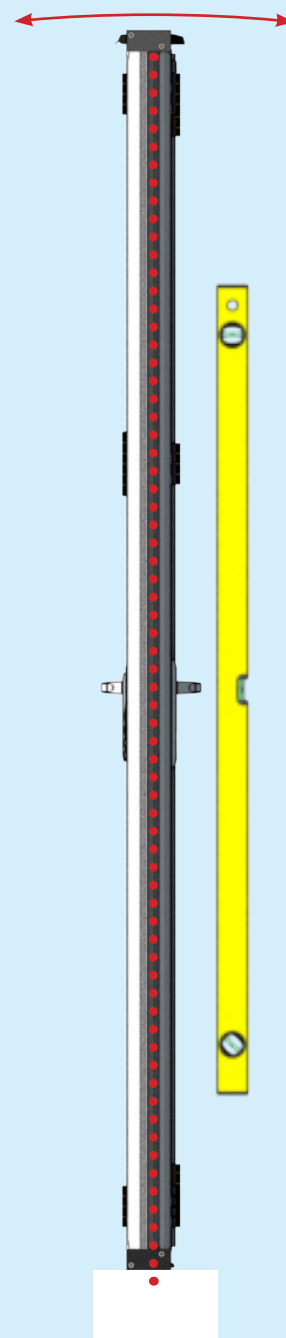

3 Horizontal alignment

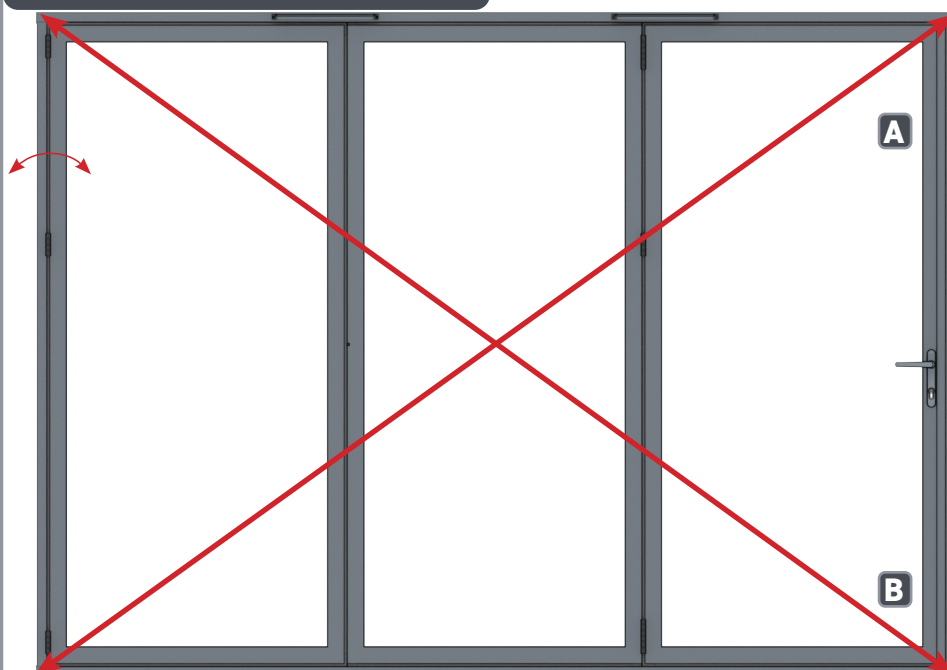

Ensure diagonals: $A=B \pm 1\text{mm}$

DOOR INSTALLATION

A5



Outer frame
packers
(not supplied)



Frame fixing
screws
(not supplied)



Low modulus
silicone sealant
(not supplied)

4 Packing of outerframe

(Dimensions are
approximate)

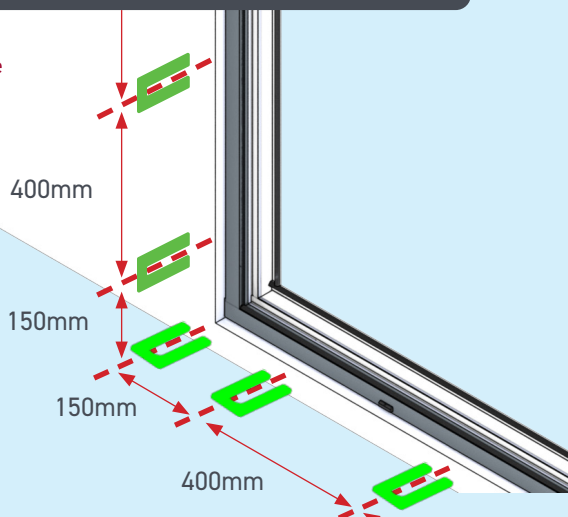

Ensure outerframe is packed level $\pm 1\text{mm}$

5 Drill and screw outerframe in position



Ensure screws
are sub-flush
to avoid clash
with rollers

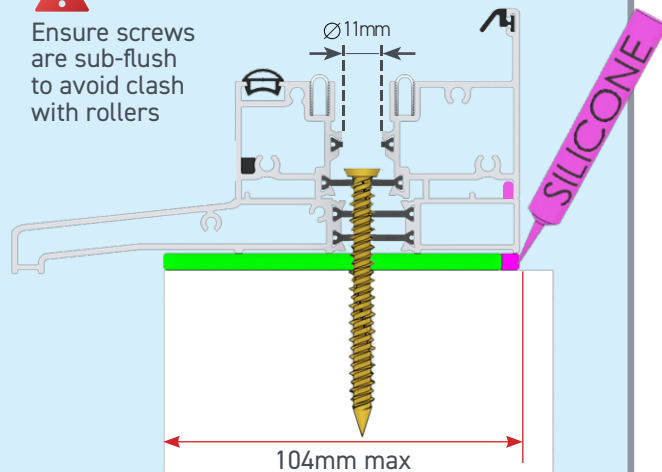

Do not use drainage holes for screws

6 Check vertical measurements

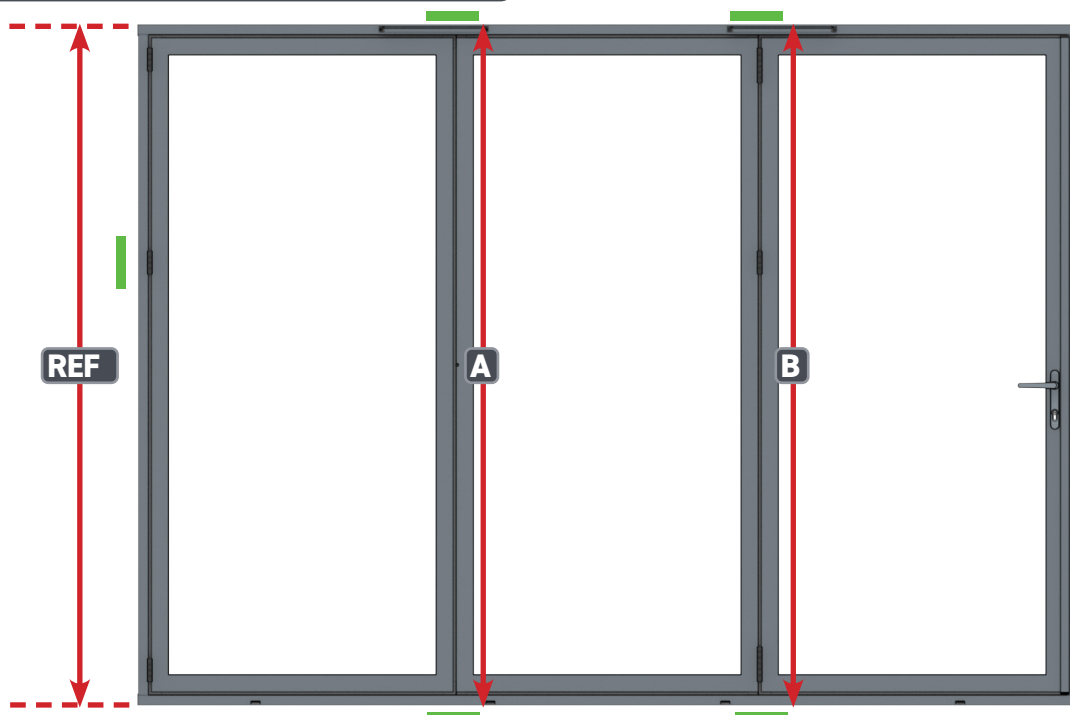

Reinstall
any removed
keeps



Ensure verticals: $\text{REF}=\text{A}=\text{B} \pm 1\text{mm}$

We recommend adding extra packers at locking points and hinges

DOOR GLAZING

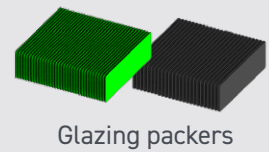
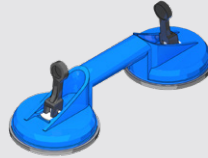

2 Glazing of sashes

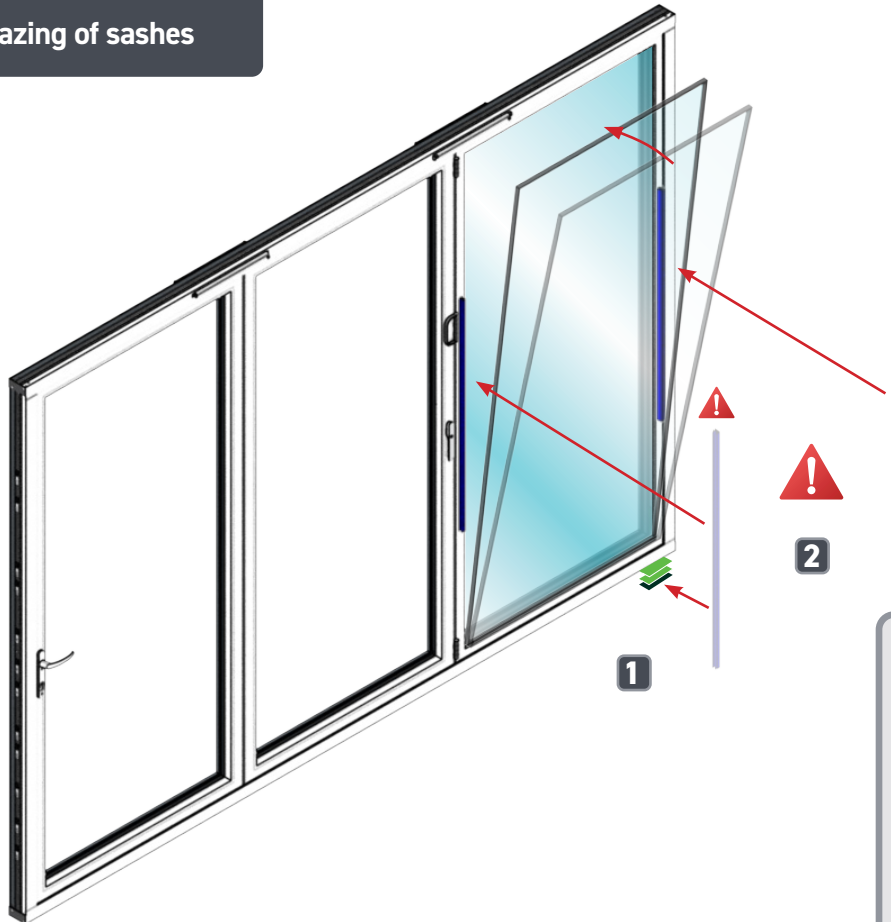

Suggested Packing

| | | |
|-----|---|---|
| 1mm | + | — |
| 1mm | + | — |
| 2mm | + | — |

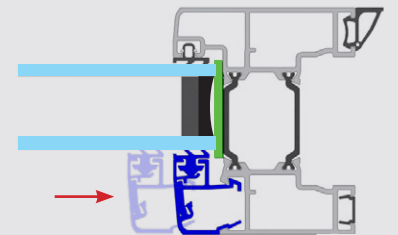

Tip: Use horizontal beads to temporarily secure glass: Refer to appendix 2

Toe and heel adjustment



11mm

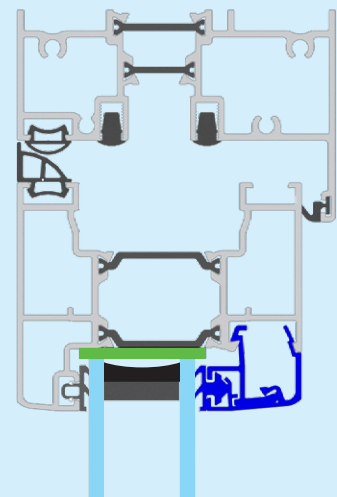

Adjust sash packing to maintain 11mm all round

DOOR FUNCTIONALITY

A6

Shootbolt key
A-03883

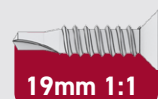

KITFORM
ONLY

A-03309 - Final hinge screw

KF

1 Check door functionality

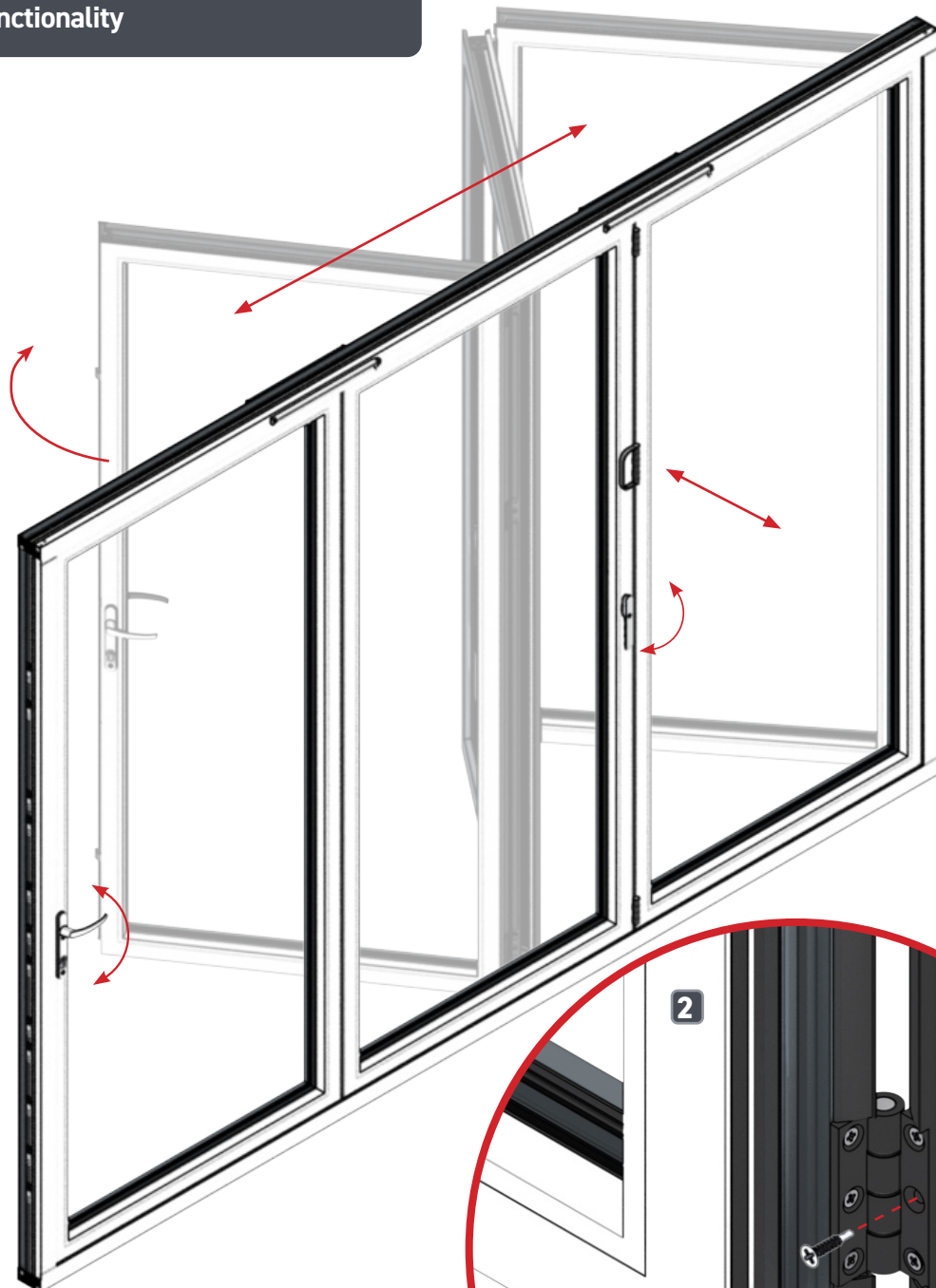

2

Final screw
fixing



Check sashes are inline and gaps are equal to 11mm, if adjustment is required remove centre (final) hinge screws, loosen top and bottom screws, reposition from hinge and tighten/replace all fittings.

ADDITIONAL PACKING AND REFITTING BEADS

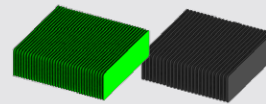

Optional additional
Glazing packers

3 Pack at locking and hinge points

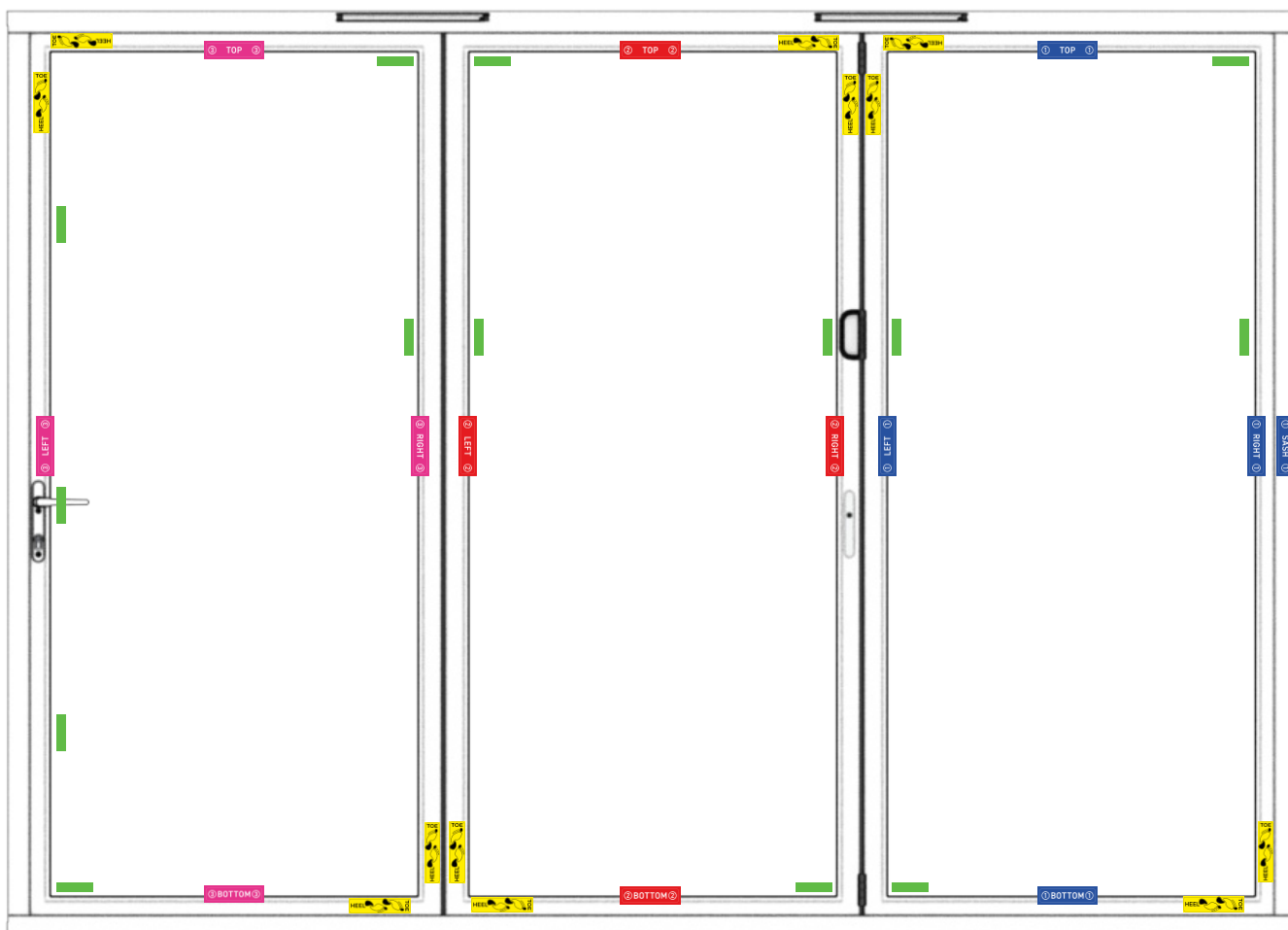

4 Clip-in bead installation

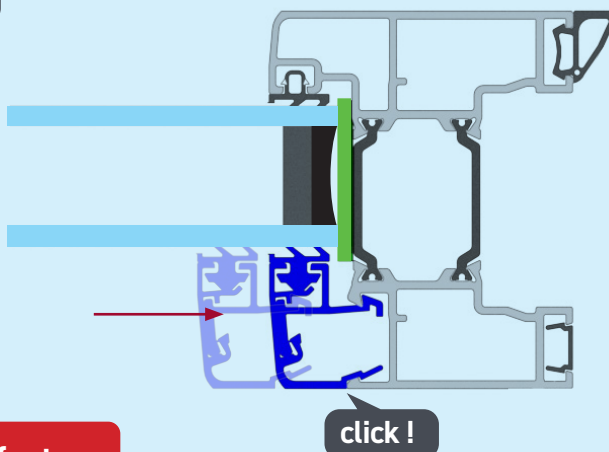

Fit horizontal beads first

DOOR MAGNET INSTALLATION

A7



3mm Drill Bit



Magnets
A-03948

2 Door magnet installation

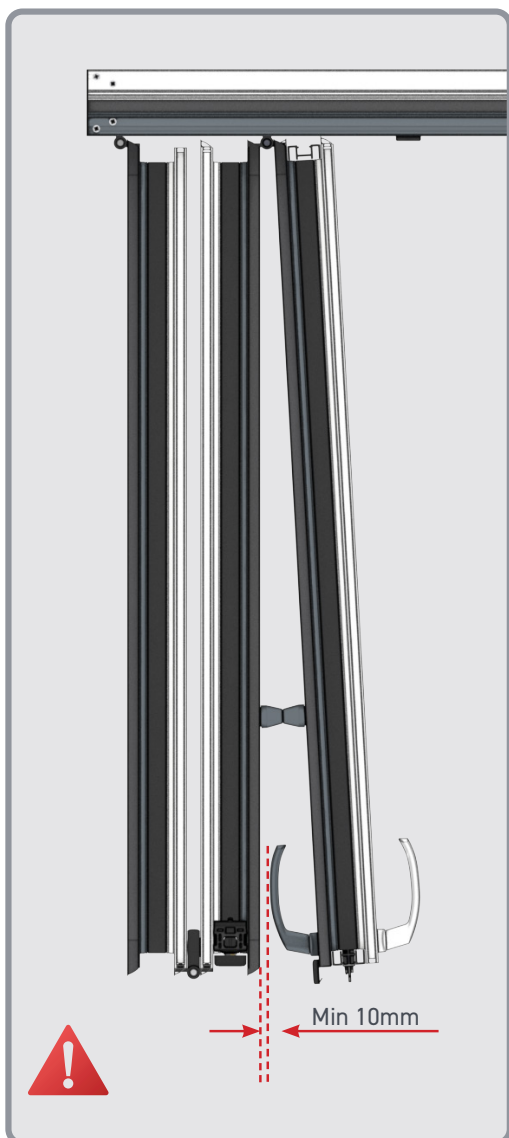

Position magnet to ensure 10mm gap



Ensure magnets are contacting concentrically

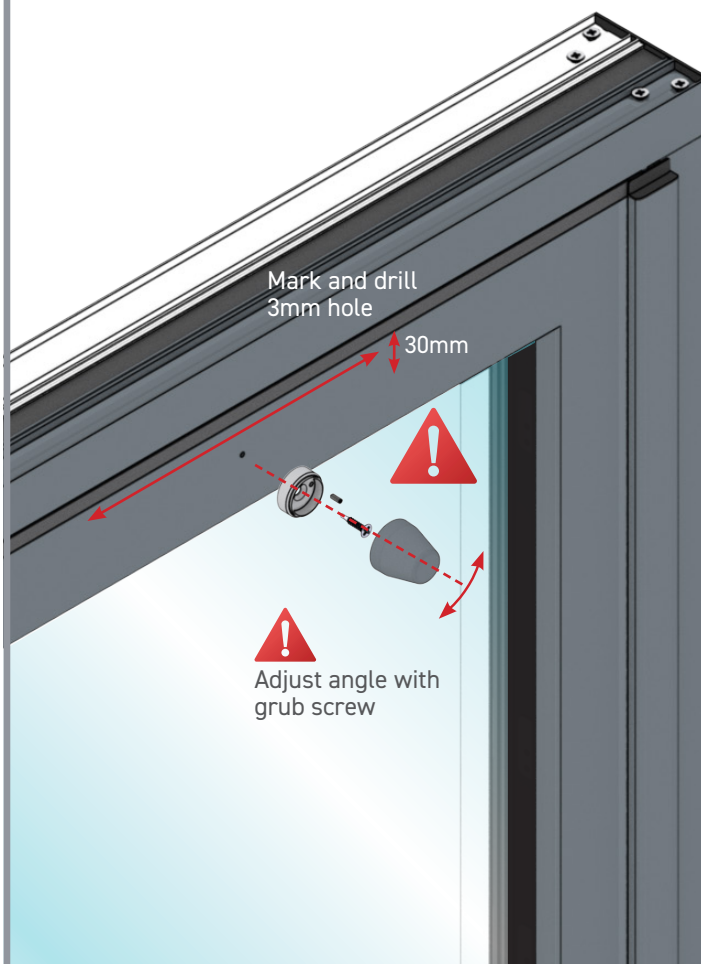

Mark and drill
3mm hole

30mm



Adjust angle with
grub screw



Position grub screw opposite hinges and adjust angle to ensure magnets touching faces are concentric and parallel.

LOCK ADJUSTMENT

B1



Before adjusting lock ensure door frame and glazing is correctly packed

1 Latch plate adjustment



2 Roller cam adjustment using 4mm hex key



3 Hook keep adjustment using 4mm hex key

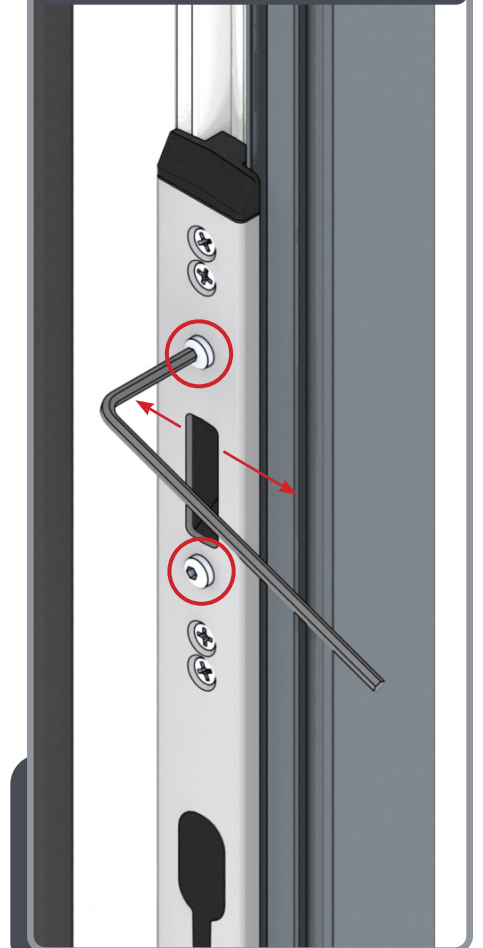

KIT-FORM ONLY ASSEMBLY

KF

C1

60mm 1:1

A-03310



1



First remove any frame extenders, retaining screws for later

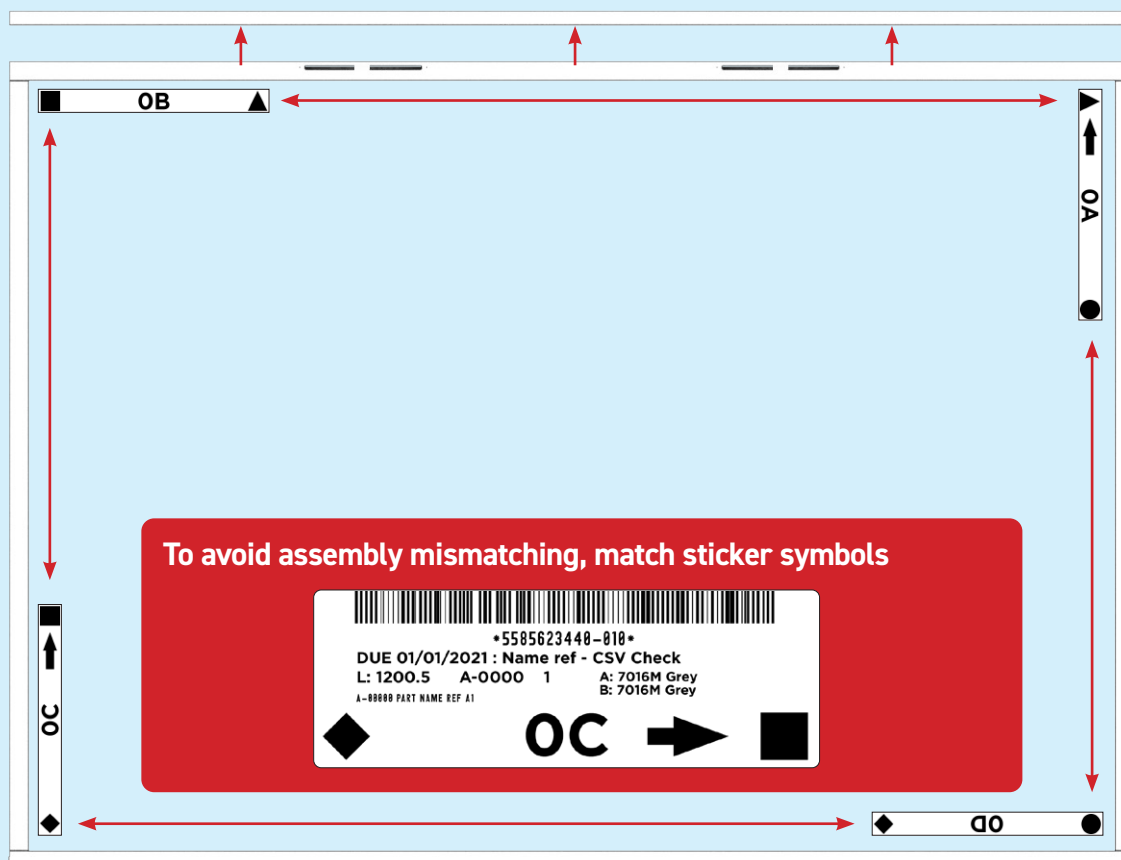

To avoid assembly mismatching, match sticker symbols

2 Outerframe assembly

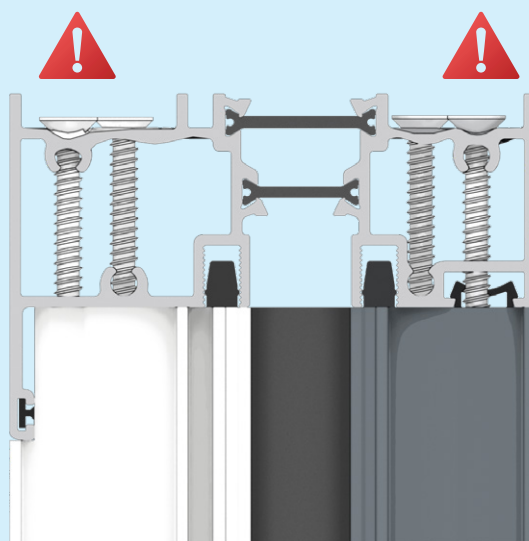
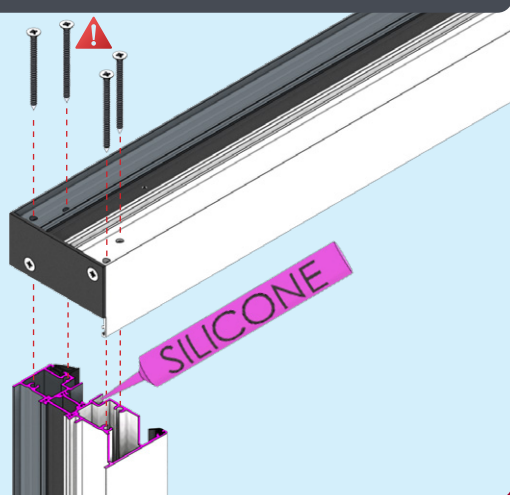

To avoid distortion do not over-tighten

OUTERFRAME ASSEMBLY

KF



A-3732



3 Re-attach optional frame extender

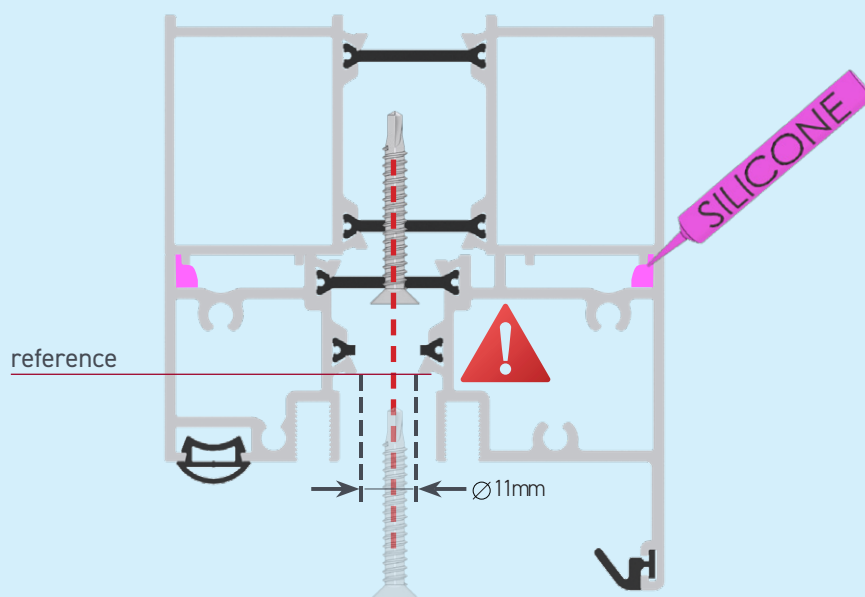

Ensure screws are sub-flush to reference line

4 Fixing position of optional frame extender to outerframe

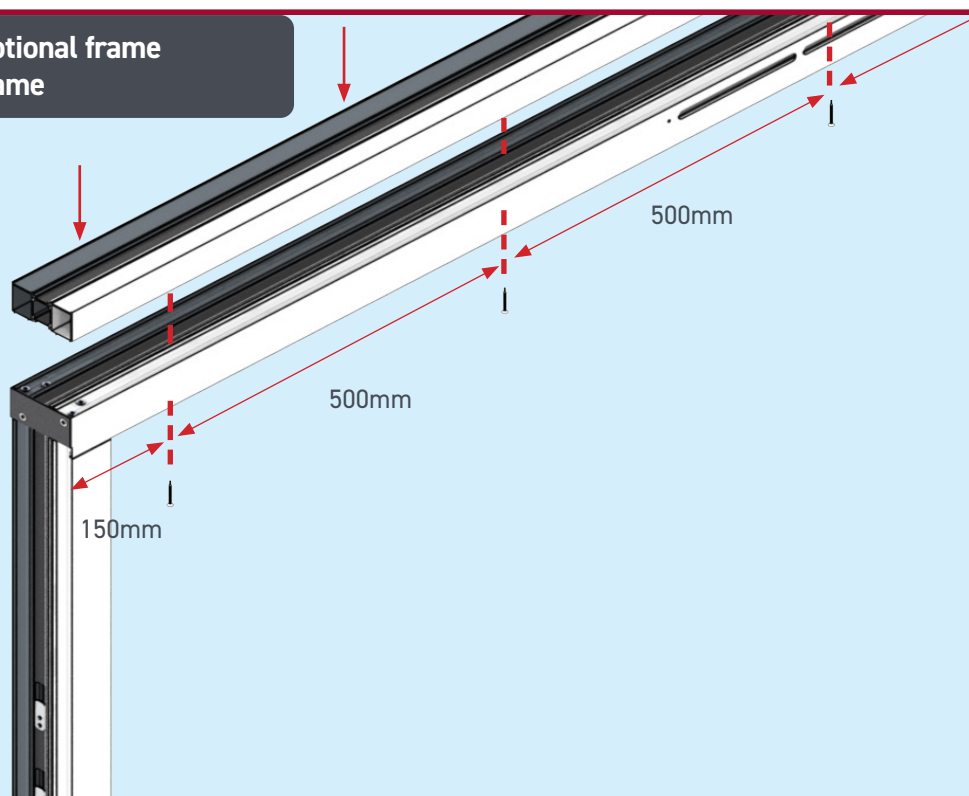

C2

Rotate sash into position

Top of frame

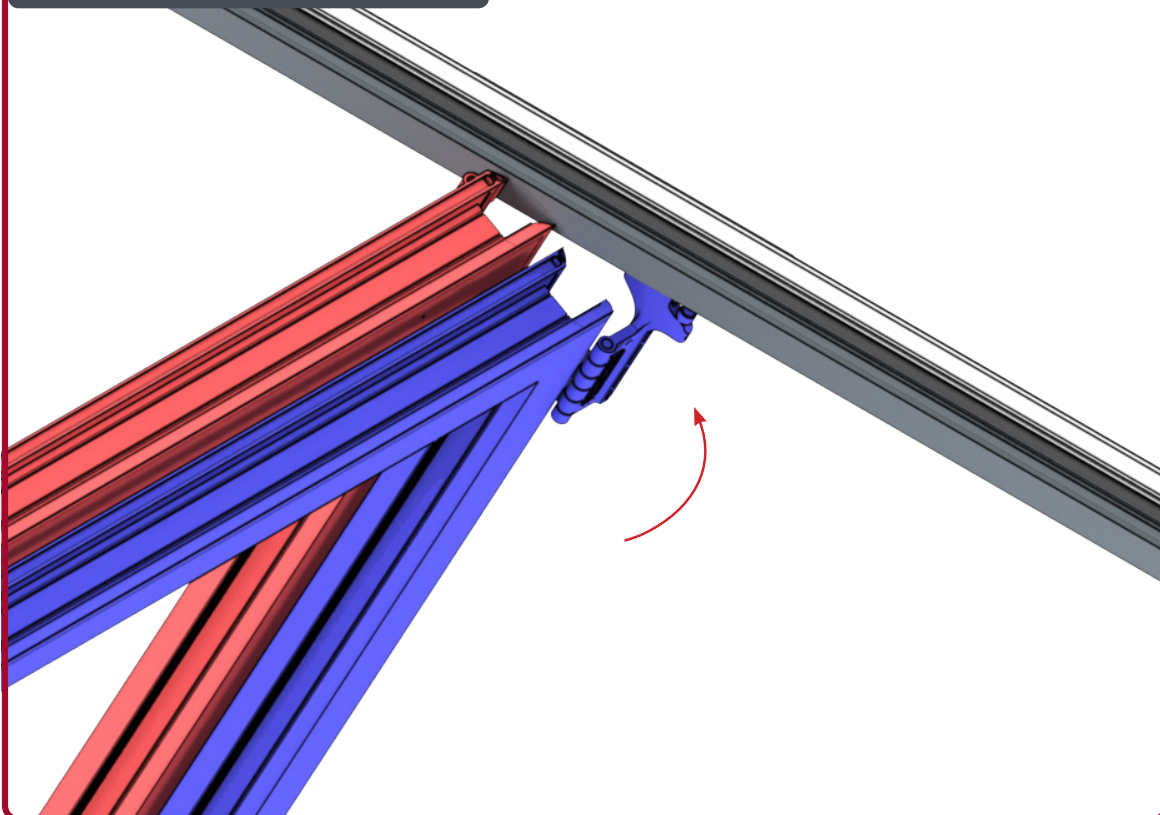

Bottom of frame

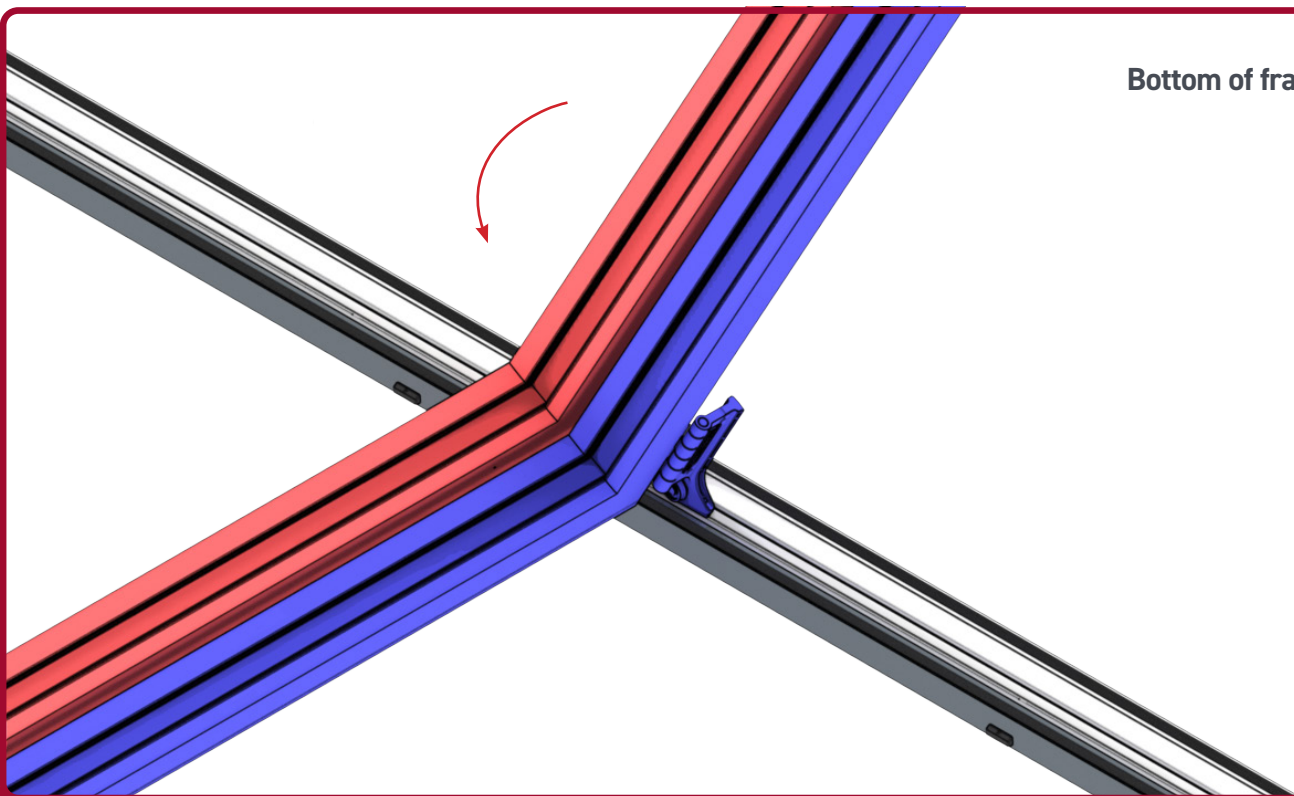

SASH INSTALLATION

KF

10mm 1:1
A-03735

Sash attachment - external view



Do not install centre screw until stage A6

A

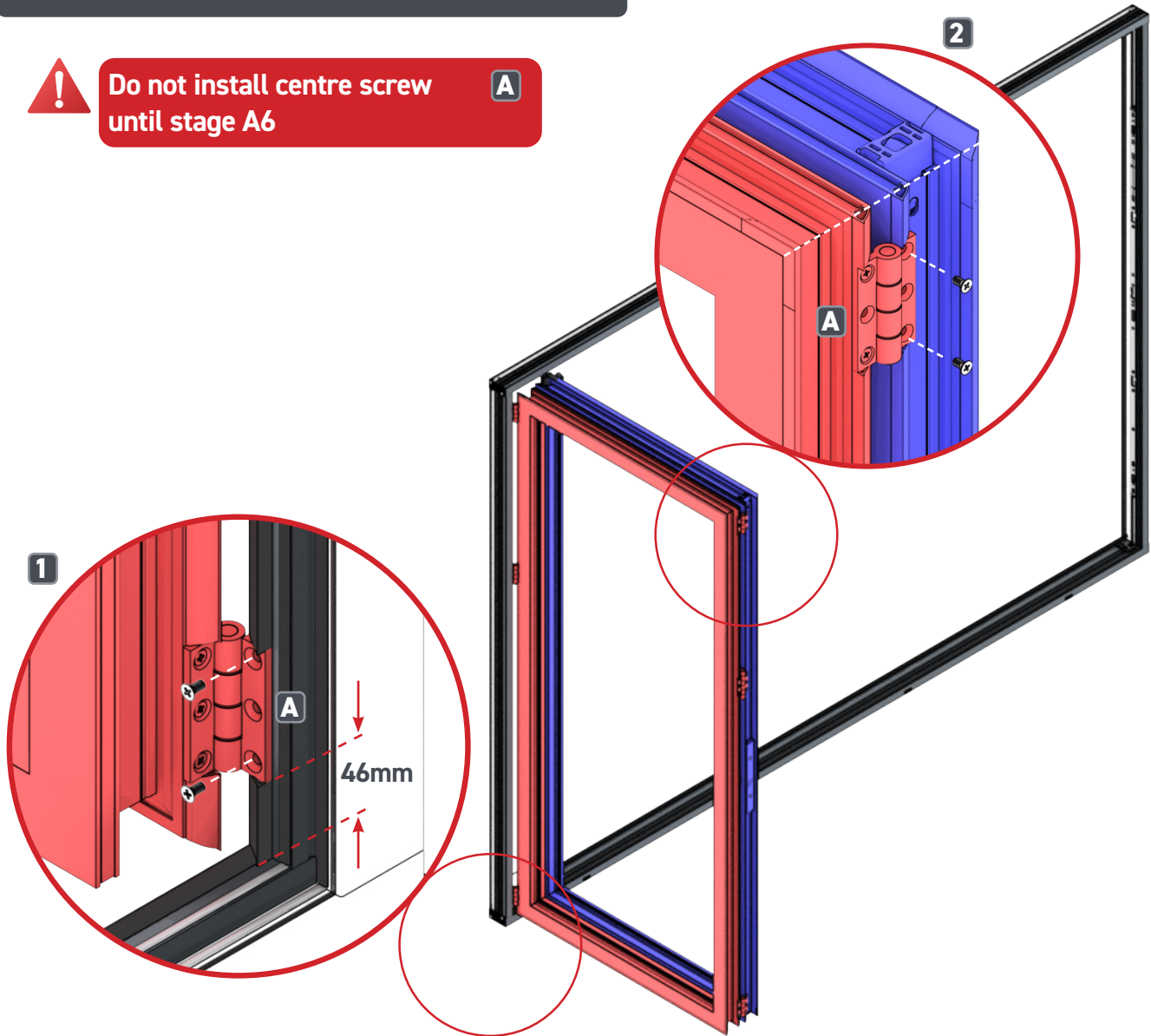

Align sashes using hinge screws to adjust heights (sashes are numbered left to right from outside)



End of Kit-form instructions

BEAD REMOVAL WHEN REGLAZING

D1



De-glazing tool
A-00424

! Ensure tool and glass are clean to avoid scratches

Bead removal order

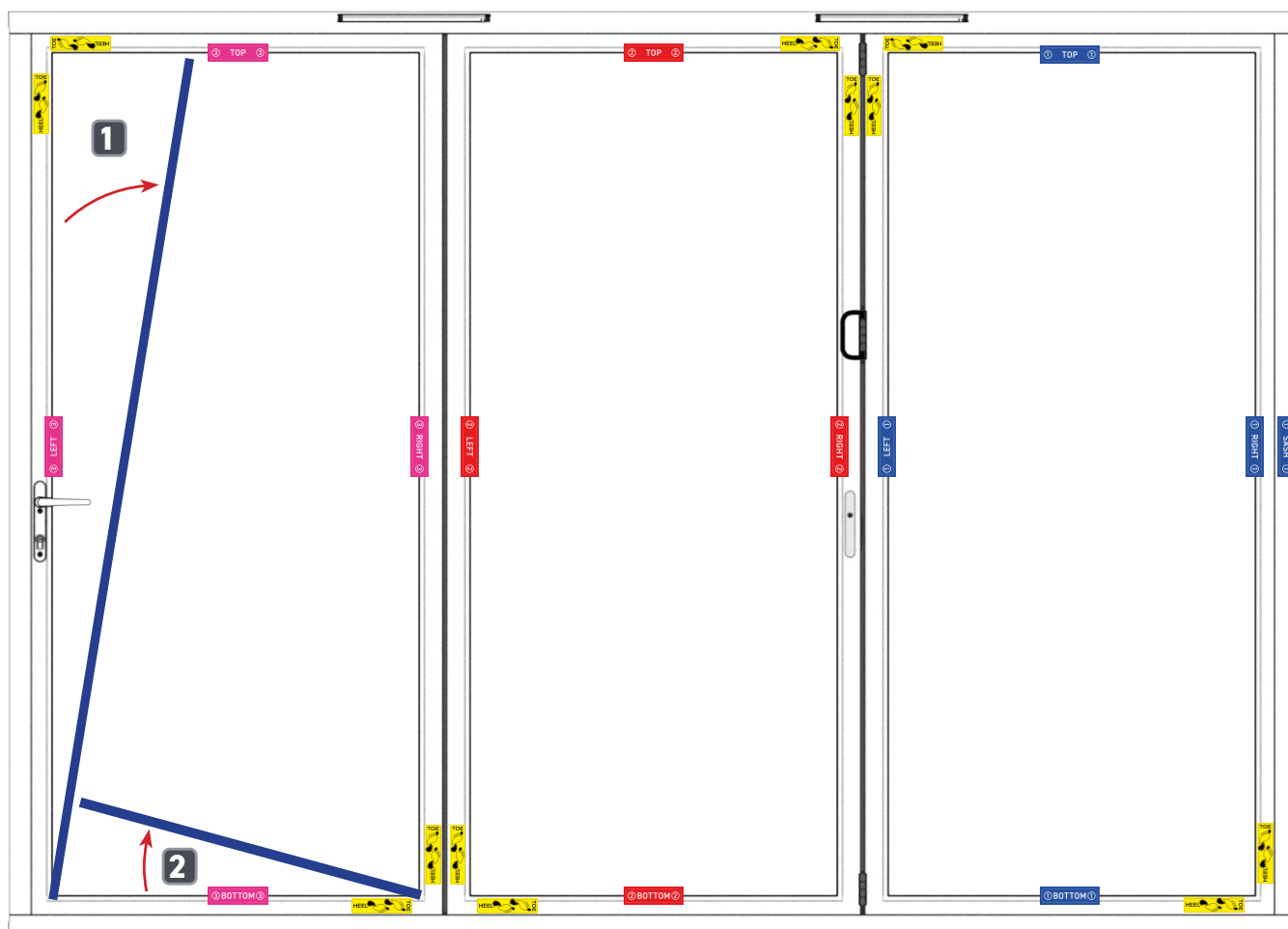

BEAD REMOVAL WHEN REGLAZING

1 Push tool into seal



Tip: To aid bead removal apply WD-40 to tool tip

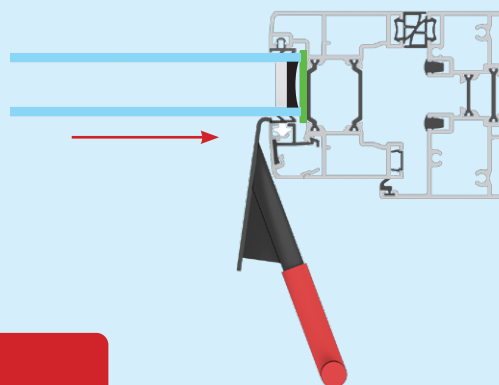

2 Maintain pressure and rotate handle towards glass

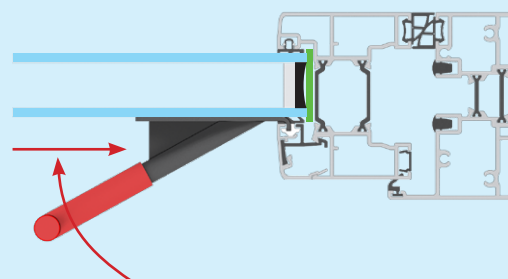

3 Pull along the glass direction to release

